

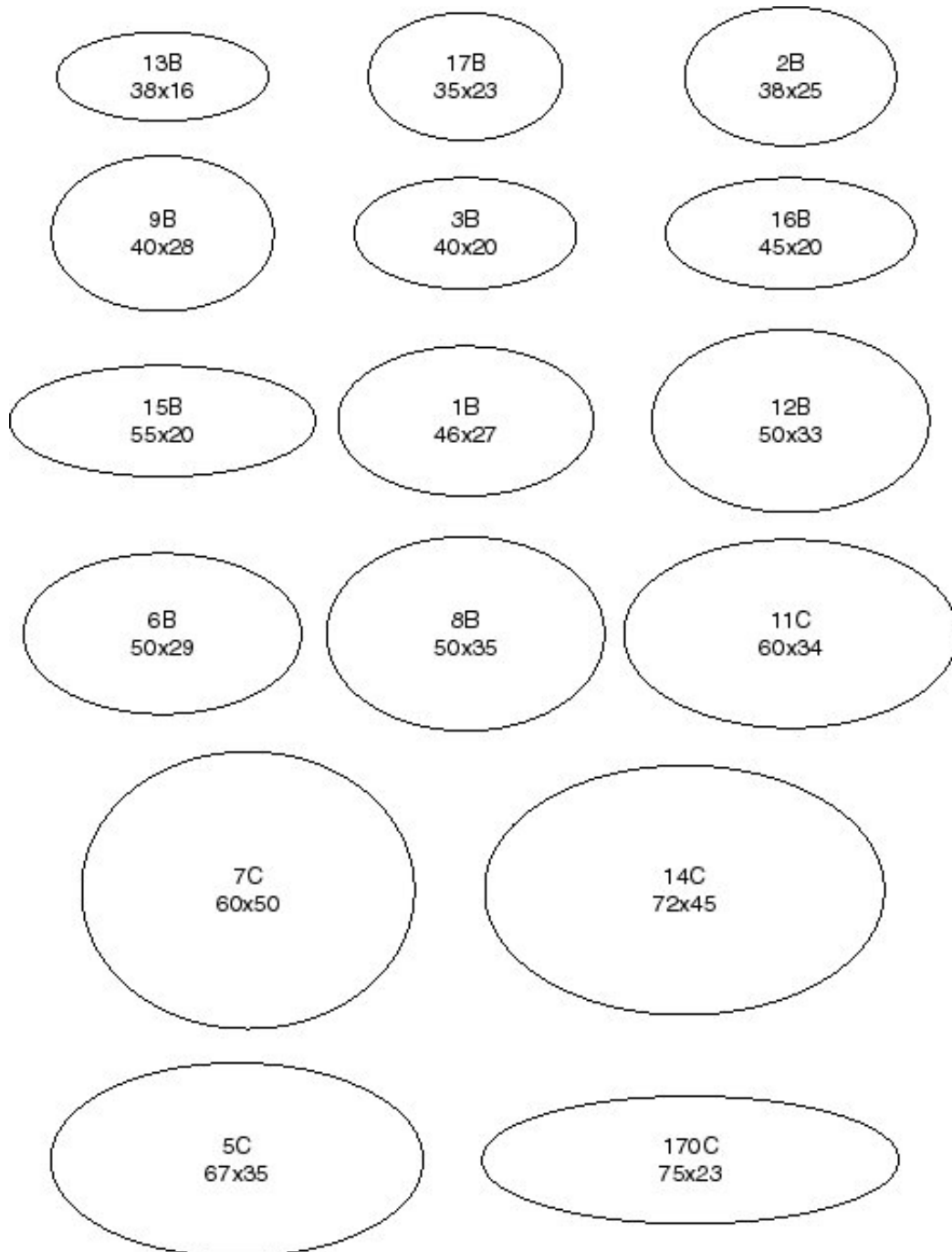

BAGSTAGE
DIE TRAGETASCHEN COMPANY

Stanzformen Schmucketiketten

Oval:





BAGSTAGE
DIE TRAGETASCHEN COMPANY

Eckig:

54C 95x25	174C 60x25	
83B 35x20	80B 38x20	
52C 69x29	57B 35x30	131B 30x30
56B 40x25	72B 50x25	66B 40x24
65B 58x21	74B 45x20	67B 50x20
51B 50x29	84C 60x30	58B 49x30
60B 65x35	127B 35x35	63B 55x35



BAGSTAGE
DIE TRAGETASCHEN COMPANY

Dreieckig:

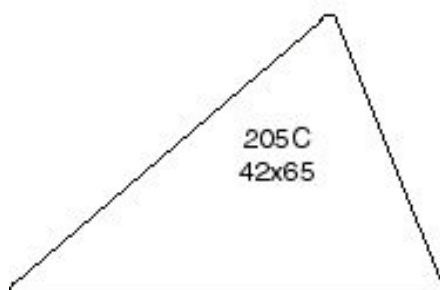
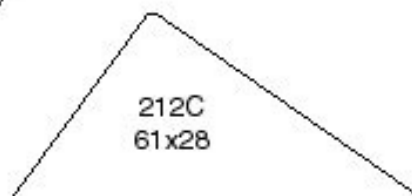
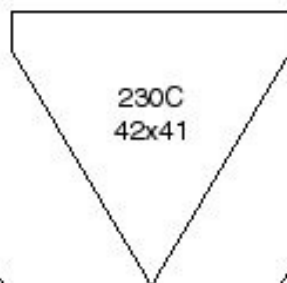
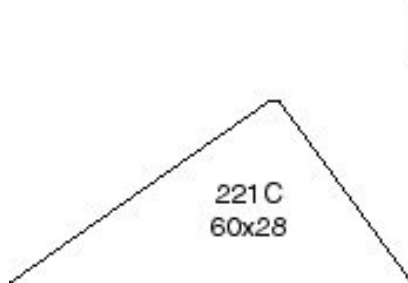
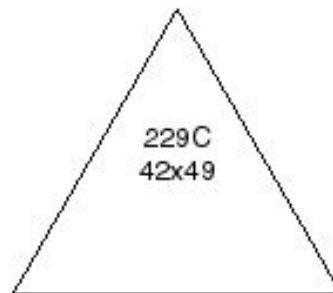
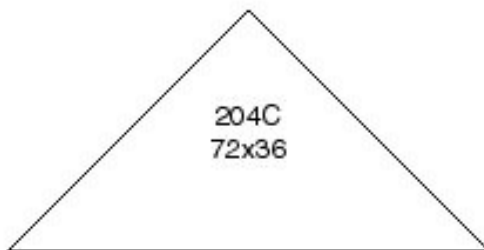
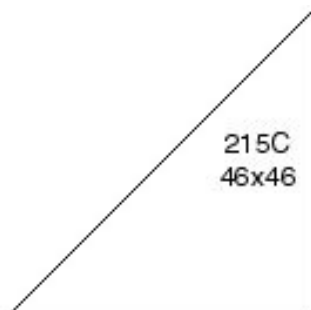
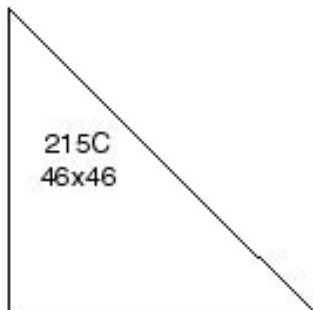



BAGSTAGE
DIE TRAGETASCHEN COMPANY

Sonderformen:

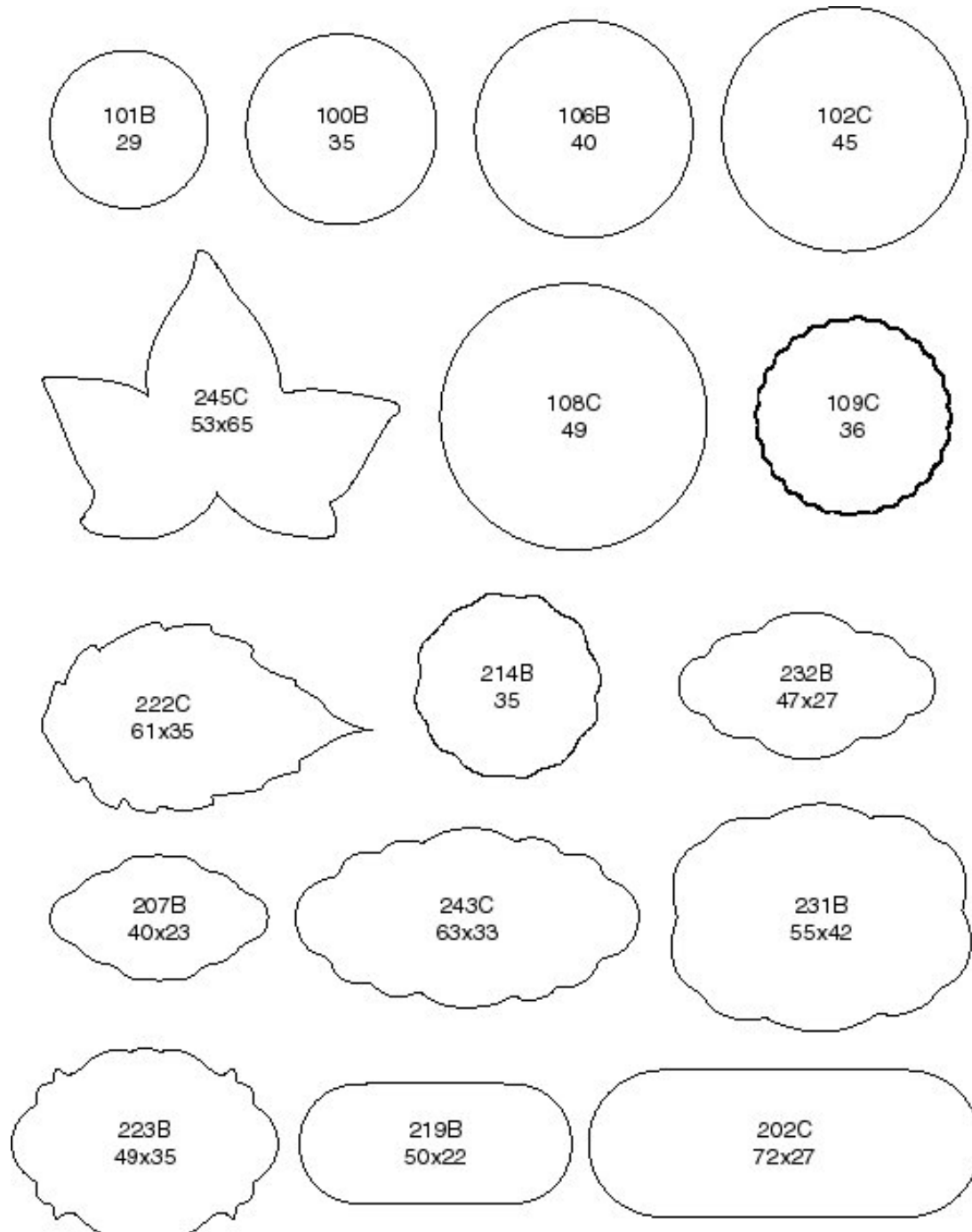

Sie haben noch Fragen? Gerne werden wir diese beantworten!
Email: info@bagstage.de - Webseite: www.bagstage.de
Tel: 0211/1576070-0